



New Hope-Solebury School District High School Revitalization Plan Scope Review

5 August 2015

GODSHALL KANE O'ROURKE ARCHITECTS, LLC

12 East Butler Avenue, Suite 205, Ambler, PA 19002

T: 215.646.2003 F: 215.646.5707 www.gkoarchitects.com



Project Fundamentals – what every scheme should include:

- 1 Relocate High School Drop-off away from Bridge Street**
- 2 Safety and Security:**
 - Create a Secure Vestibule for access to the High School and Middle School Administration areas.
 - Eliminate outside student circulation; MS to HS, to Weight Room, Science Wing to Main Bldg.
 - Separation of Ceramic classroom from the overall Art classroom.
- 3 Address Education Program Instructional Space Deficiencies :**
 - Increase Science Program Offerings
 - Provide Space for Large Group Instruction
 - Provide Additional Instructional Spaces to Address Program Needs
- 4 Infrastructure Improvements:**
 - ADA Improvements; Vacate non-accessible classrooms, address locker & toilet rooms
 - Address immediate weather concerns at Gyms and Butterfly Courtyard
 - Replace older windows at '38 and 50's Buildings (No Insulated Glass)
 - Update Fire Alarm System to current standards
 - Replace HVAC System and Controls with Energy Efficient System
 - Replace Older Transformers and Electrical Panels (Safety Issue)
 - Replace Clock, Public address and Data Systems (Safety Issue)

Long Range Plan Items Suggested to be included in Scope of Project:

Priority One to be included in the Project

Estimate \$ 1,030,000

- Improve Field #2; Re-surface track, Re-grade field, Re-sod field and add slot drains
- Connect the West parking lot through the wooded area to the UES
- Install wayfinding signage throughout the campus
- Create a system of ADA approved pathways around the campus fields
- Replace Fitness equipment to Address Federal Initiatives
- Provide Furniture and equipment for Cyber Classroom for 21st Century Teaching

Priority Two for Consideration for inclusion in the Project

Estimate \$ 1,000,000

- Relocate Maintenance building to area next to Stadium
 - Relocate Weight room building to area next to stadium for copy center
 - Stadium New building to house rest rooms, press box, snack stand, team rooms
 - Replace Tennis Courts at present location- 6 courts
 - Install irrigation system at Field #9 for maintaining grass turf,
Install underground utilities, close swale and install sidewalk
 - Develop one additional Irrigation well and improve water connections to fields
- * All priority two items above could be documented as Alternates to give the District some additional flexibility to determine the final scope once bids are received.

Priority Three - Long Range Planning

Estimate \$ 4,630,000

Stadium

Estimate \$ 5,500,000



Items to be addressed outside the Project:

Maintenance Items to be addressed in a 5 Year Plan

Estimate \$ 410,000

- Repairs to storm water inlets
- Replace HS Stage Curtain
- Update HS/MS Kitchen Equipment; oven, steamer & dishwasher
- Miscellaneous Exterior Painting
- Recoat all Parking Lots surfaces where Needed
- **Repair Exterior Concrete Sidewalks**
- **Paint exterior doors**
- **'38 building roof**
- **Basement water management**
- **Remove abandoned Water Tank**

Long Rang Plans Beyond Maintenance

Estimate \$ 9,720,000

- Field Improvements; Regrading, Irrigation Systems, Well, Drainage, Additional Score Boards, Permanent Home Run Fence, Turf Fields and Stadium.
- Additional Parking Lots, drives and walks shown on Master Plan
- Add Storage Mezzanine at maintenance building.
- New Elementary school Play Area at UES
- New Gymnasium at LES
- Auditorium Improvements (beyond summer project); acoustic shell, additional lighting & microphones
- **VCT Flooring in MS Corridor and Classrooms**
- **VCT Flooring HS Classrooms**
- **Add Automatic Door Openers**

*** Red indicates Infrastructure Items not included in option 2B Project cost.**



New Hope-Solebury School District

Options

Program Option 2B:

- ❑ LGI in Courtyard
- ❑ Infill Butterfly Courtyard
- ❑ Music Rooms relocated
- ❑ MS Auxiliary Gym
Constructed to replace existing Stage.
- ❑ Provide Teaching Spaces to meet program needs in HS

❑ Budget:

Infrastructure = \$10,664,150

Approx. Total \$28,550,000

Does Not Include:

Long Range = \$ 1,030,000
\$29,580,000



High School

Space	Existing	2B
❑ Classrooms	(20)	25
❑ Science Rooms	(6)	7
❑ Sm. Group Instruction	(5)	6
❑ Art Room	(1)	2
❑ Music Rooms	(3)	3
❑ Tech Rooms	(2)	2
❑ Lrg Group Instruction	(0)	1
❑ Multi Media CR	(0)	1

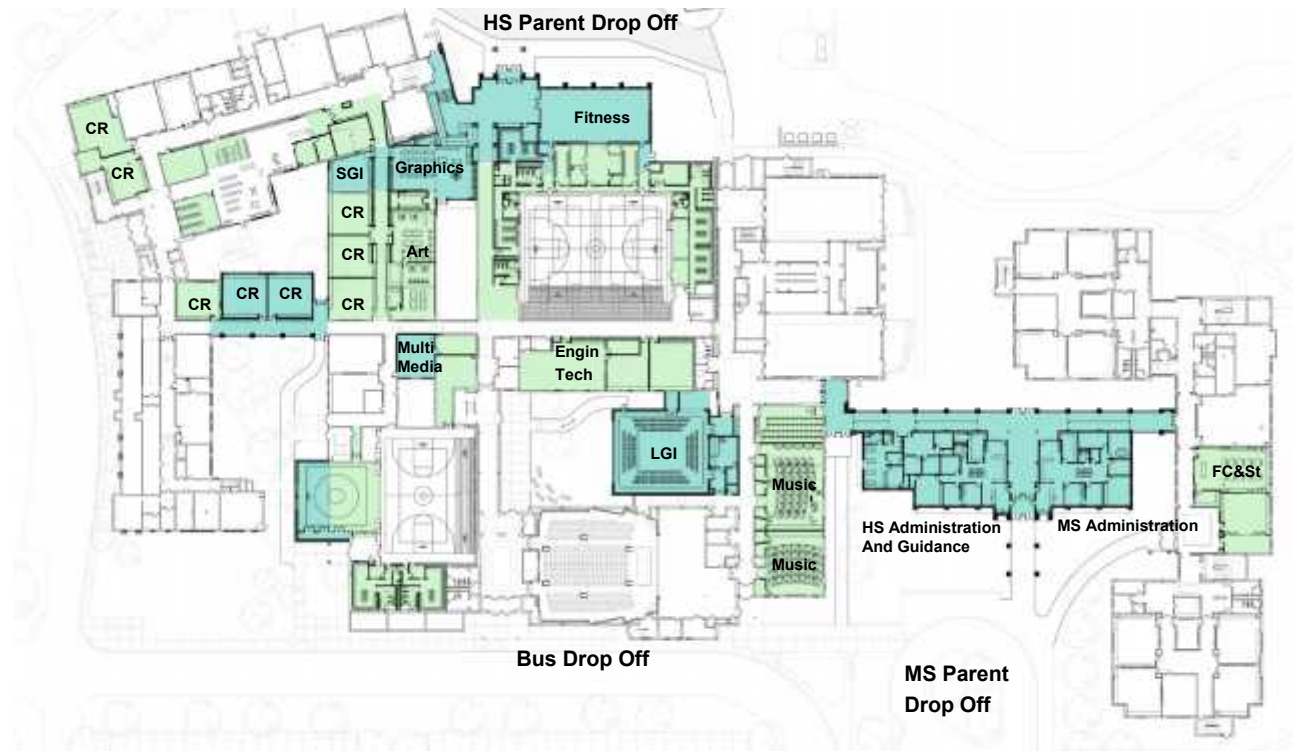

New Hope-Solebury School District

Program Option 2B-Features

Meets Educational Program and Supports Future Goals:

- ✓ New LGI
 - Classes over 30 students
 - Space for standardized testing
- ✓ Additional Classrooms and SGI
 - Ability to expand educational offerings
- ✓ Additional Science Lab Space
 - Ability to expand educational offerings
- ✓ Additional Art Classroom
 - Separation of Ceramics Studio
- ✓ Expansion of MS Aux Gym
 - Separate Wrestling room and Provide Teaching Space
- ✓ Infill Butterfly Courtyard
 - Provide Multi Media Classroom and studio
 - Eliminate Water infiltration
- ✓ Renovate Music and Tech Ed
 - Maintain Number of Spaces and Improve Teaching Environment
- ✓ Repair track Maintain Field
 - Maintain track for continued use for meets and Physical Education classes

Program Option 2B-Features

Safety and Security:

- ✓ Secure Entrances
- ✓ Centralized Administration Offices for security
- ✓ Address exterior circulation for students (3 locations)
- ✓ Renovate and Reorganized MS Locker Rooms

New Amenities:

- ✓ Relocate/New Fitness Center
- ✓ New Auxiliary Gym
- ✓ Large Group Instruction
- ✓ Expanded Art Room
- ✓ Moves Music Rooms near Stage Area
- ✓ 5 Additional Classrooms
- ✓ 1 Additional Science Room
- ✓ 1 Multi Media Conference Room

Improved Community Access:

- ✓ Connection of East and West Entrances with Corridor

Infrastructure Improvements throughout

- ✓ Finishes and Equipment
- ✓ Mechanical, Electrical & Plumbing Systems
- ✓ Address current ADA classroom accessibility issue

New Hope-Solebury School District

Program Option 2B-Infrastructure Upgrades

Architectural Features:

- ✓ Replace Older Windows
- ✓ Weather Protection repair to Exterior Walls at Gymnasiums
- ✓ New Finishes, Flooring, Ceilings and Paint In public areas And Gyms
- ✓ New Lockers
- ✓ New Casework in '38 Building and balance of Science Rooms
- ✓ Accessibility Upgrades to Public spaces
- ✓ Accessibility access to all teaching spaces

Plumbing Features:

- ✓ Provide Automatic Flush Valves to conserve water
- ✓ Replace older Drinking Fountains

Mechanical Features:

- ✓ New High Efficiency Boiler Plant
- ✓ Central Chiller for High School
- ✓ Replace older Unit ventilators
- ✓ Improve Air Conditioning System for Middle School
- ✓ New HVAC Controls

Electrical Features:

- ✓ New Generator capable to handle additional loads
- ✓ Replace Older electric panels in '38 building
- ✓ New fire Alarm system for both the High School and Middle School
- ✓ Additional Security system including Door Access Control and Camera Locations
- ✓ Upgrade to Data system distribution cable.
- ✓ Energy efficient LED Lighting thru the Public spaces
- ✓ New Sound systems for Gym and Auditorium
- ✓ New Integrated Clock system and Public Address System for High School and Middle School

\$25M Program Option:

Reductions included:

- ❑ LGI as Alternate.
- ❑ MS Auxiliary Gym expansion as alternate.
- ❑ New Classrooms at Senior Corridor Eliminated
- ❑ Senior corridor not replaced.
- ❑ Music Rooms remain in current location.
- ❑ Renovate Tech Lab into additional Music Room.

Budget:

Infrastructure = \$ 8,206,650

Long Range = \$ 1,030,000

Approx. Total \$24,592,500

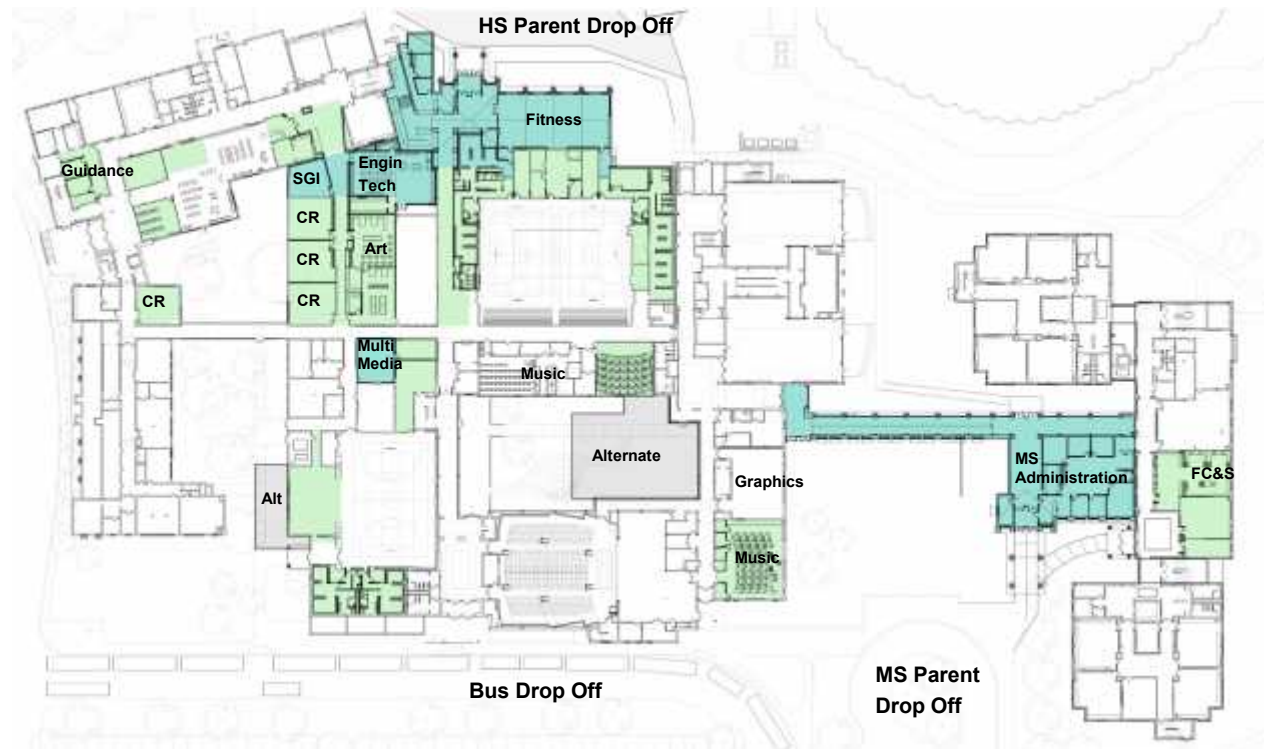

High School

Space	Existing	2B	25M
❑ Classrooms	(20)	25	20
❑ Science Rooms	(6)	7	7
❑ Sm. Group Instruction	(5)	6	5
❑ Art Room	(1)	2	2
❑ Music Rooms	(3)	3	3
❑ Tech Rooms	(2)	2	2
❑ Lrg. Group Instruction	(0)	1	0
❑ Multi Media CR	(0)	1	1

New Hope-Solebury School District

\$25 Million Program Option – Reductions From Original 2B Scheme

Educational Program Reductions:

- ✓ New LGI Eliminated
 - Must use Buck Auditorium for classes over 30 students
 - No new space for standardized testing

- ✓ New Additional SGI Eliminated
 - Impacts Educational Program

- ✓ New Additional Classrooms Eliminated
 - Cannot Expand Educational Program Offerings
 - Same Number of Classrooms as Current

- ✓ Expansion of MS Aux Gym Eliminated
 - No separate Wrestling room

New Hope-Solebury School District

\$25 million Program Option – Reductions From Original 2B Scheme

Architectural Program Reductions:

- ✓ Delete LGI Addition
- ✓ Do not relocate the Music and Graphic Arts Spaces
- ✓ Keep Nurse in existing location
- ✓ Do Not Relocate HS Administration
- ✓ Do Not Rebuild Senior Corridor or add 2 Classrooms
- ✓ Do not expand the MS Aux Gym (Lower Existing Floor)

Approximate Sub-total **-\$2,510,000**

Infrastructure Reductions:

- ✓ Do not replace worn finishes in MS

Plumbing Features:

- ✓ Do not provide Automatic Flush Valves

Mechanical Features:

- ✓ New Central Chiller for HS but reuse '97 AHU's (where Feasible)
- ✓ Eliminate additional 2 pipes to Air Conditioning System for MS
- ✓ Keep Existing Boilers and only Add 1 High Efficiency Boiler
- ✓ Consider Using Vertical Classroom Air Handlers in lieu of VAV

Electrical Features:

- ✓ Do not provide new Data at Middle School
- ✓ Do not replace Lighting at Middle School
- ✓ Do not provide Lighting Controls at MS
- ✓ Do not provide Daylight Harvesting
- ✓ Do not provide access control(could be done later)
- ✓ Do not provide CCTV (could be done later)
- ✓ Do not replace Gymnasium Sound System (could be done later)
- ✓ Do not upgrade Exterior Lighting (Alternate, Price is not in Budget)

Approximate Sub-total **- \$2,427,500**

- ✓ Include Long Range Plan features ----- **+\$1,030,000**

Total \$24,592,500



\$20M Program Option:

Reductions Include:

- ❑ Large Group Instruction Eliminated
- ❑ New Science Room Eliminated
- ❑ Expansion of MS Aux Gym Eliminated
- ❑ New CRs at Senior Corridor Eliminated
- ❑ Senior Corridor is not replaced.
- ❑ Fitness Center size is reduced.
- ❑ 3 Exist Non-accessible Classrooms Remain.
- ❑ No long Range Planning

❑ Budget:

Infrastructure = \$ 7,206,650

Long Range = \$ 0

Approx. Total \$20,955,000

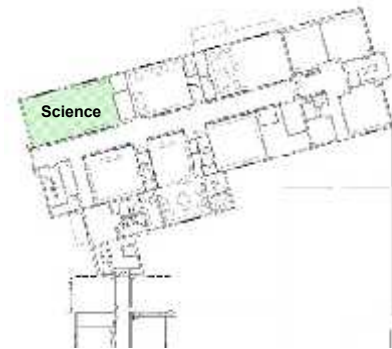

High School

Space	Existing	2B	25M	20M
❑ Classrooms	(20)	25	20	20
❑ Science Rooms	(6)	7	7	6
❑ Sm. Group Instruction	(5)	6	5	5
❑ Art Room	(1)	2	2	2
❑ Music Rooms	(3)	3	3	3
❑ Tech Rooms	(2)	2	2	2
❑ Lrg Group Instruction	(0)	1	0	0
❑ Multi Media CR	(0)	1	1	0

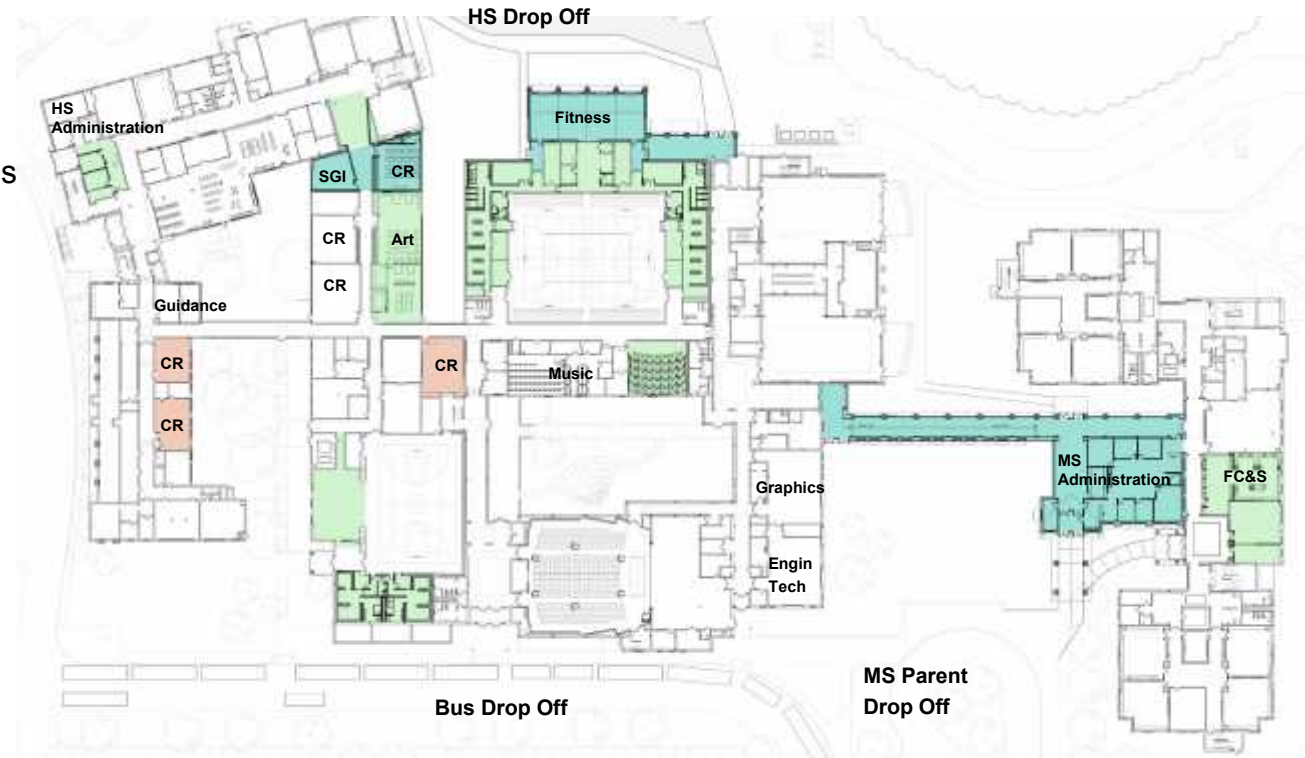

New Hope-Solebury School District

\$20 Million Program Option – Reductions From Original 2B Scheme

Educational Program Reductions:

- ✓ New LGI Eliminated
 - Must use Buck Auditorium for classes over 30 students
 - No space for standardized testing

- ✓ New Additional Classrooms Eliminated
 - Cannot Expand Educational Program Offerings
 - Same Number of Classrooms as Current

- ✓ New Additional SGI Eliminated
 - Impacts Educational Program

- ✓ Expansion of MS Aux Gym Eliminated
 - No separate Wrestling room
 - Impacts Physical Education Program

- ✓ Butterfly Courtyard not Infilled for Usable Space
 - No Multi Media Classroom and studio

- ✓ Music and Tech Ed not Renovated
 - No Additional Music Space

- ✓ Track not Repaired
 - Will not able to use track for meets in the future
 - Impacts Physical Education Program

New Hope-Solebury School District

\$20 Million Program Option – Reductions From Original 2B Scheme

Architectural Program Reductions:

- ✓ Delete LGI Addition
- ✓ Do Not relocate the Music and Tech Ed Spaces
- ✓ Do Not relocate the Nurse
- ✓ Do Not Relocate HS Administration
- ✓ Delete New Science Lab
- ✓ Do Not Rebuild Senior Corridor or add 2 Classrooms
- ✓ Reduce the new rear entrance 2,600 sf
- ✓ Do not expand the MS Aux Gym (Lower Existing Floor)
- ✓ Do Not infill Butterfly courtyard
- ✓ Reduce Art Wing connection 850 sf
- ✓ Reduce the size of the Fitness room 400 sf
- ✓ Reduce amount of renovation for FCS
- ✓ Reduce renovation at art wing to art classroom only
- ✓ Delete renovation to HS Gym

APPROXIMATE TOTAL

-\$4,095,500

High School - Program Space Inventory

Space	Existing	2B	25M	20M
❑ Classrooms	(20)	25	20	20
❑ Science Rooms	(6)	7	7	6
❑ Sm. Group Instruction	(5)	6	5	5
❑ Art Room	(1)	2	2	2
❑ Music Rooms	(3)	3	3	3
❑ Tech Rooms	(2)	2	2	2
❑ Lrg. Group Instruction	(0)	1	0	0
❑ Multi Media CR	(0)	1	1	0

New Hope-Solebury School District

Program Option Comparison

Option 2B (\$28.5 Million)	Option (\$25 Million)	Option (\$20 Million)
Educational Program Offerings are Enhanced with Additional Instructional Spaces	X Educational Program Offerings are only Slightly Expanded	X Educational Program Offerings are not Expanded
Safety and Security <ul style="list-style-type: none"> • Secure Entrances • Enclose Link • Attach Fitness center 	Secure Entrances <ul style="list-style-type: none"> X New MS Admin only • Enclose Link • Attach Fitness Center 	Secure Entrances <ul style="list-style-type: none"> X New MS Admin only • Enclose Link • Attach Fitness Center
Addresses current ADA classroom accessibility issues	Addresses current ADA classroom accessibility issues	X
Eliminates Traffic and Drop off on Bridge Street	Eliminates Traffic and Drop off on Bridge Street	X
Infrastructure Long Range Planning	Infrastructure Long Range Planning	X Reduced Infrastructure X No Long Range Planning

New Hope-Solebury School District

Program Option Comparison

Option 2B (\$28.5 Million)	Option (\$25 Million)	Option (\$20 Million)
Connection of East and West Entrances with Corridor	Connection of East and West Entrances with Corridor	X
Secure Entrances New HS and MS Admin	Secure Entrances X New MS Admin only	Secure Entrances X New MS Admin only
Address exterior circulation for students	Address exterior circulation for students	Address exterior circulation for students
Address current classroom accessibility issues	Address current classroom accessibility issues	X
Infrastructure	Infrastructure	X Reduced Infrastructure
New Science Lab for additional Science space	New Science Lab for additional Science space	X
2 Added Classrooms and replace Senior Corridor Large Group Instruction	X	X
5 Total Additional Classrooms & 1 Additional SGI	X 1 Additional Classroom	X
Expanded Art Room Separate Ceramics Studio	Expanded Art Room Separate Ceramics Studio	Expanded Art Room Separate Ceramics Studio
Move Music Dept. near Stage Added Recording Studio. New Multi Media Lab	X Music remains + one New Classroom New Multi Media Lab	X Music Remains
New Fitness Center	New Fitness Center	X
Expanded MS Aux Gym & lower floor to align w/ MS Gym	X Existing Auxiliary Gymnasium lower floor only	X Reduced Sized Fitness Center X Existing Auxiliary Gym lower floor only
New Graphics Lab	Graphic Lab remains	Graphic Lab Remains
Renovated Engineer Tech Lab	New Engineering Tech Lab	Engineering Tech Lab remains

Discussion

